



ACT MAGISTRATES COURT

836

NOTICE OF RECOGNIZANCE OF BAIL TO BE GIVEN TO THE DEFENDANT

IN THE MAGISTRATES COURT)
OF THE AUSTRALIAN)
CAPITAL TERRITORY)

File No. 21150
CC92/04111

TAKE NOTICE that on Monday September 21, 1992

BAYLISS, ALEXANDER MARCEL
FLAT 7C MACPHERSON CRT, MOORHOUSE ST. O'CONNOR
ACT 2601

are bound in the sum of \$2,000.00

1. that you appear personally at Canberra in the said Territory

on the Friday September 25, 1992, at 11:30

in the forenoon before the Magistrates Court sitting at Knowles Place,
Canberra City, further to answer the charge of

CONTRAVENE RESTRAIN/ORD. PRESENT WHEN MADE

2. that you

DEFENDANT TO FORTHWITH UPON ENTERING INTO THE BAIL RECOGNIZANCE PROCEED
TO WODEN VALLEY HOSPITAL TO BE ADMITTED AS AN INPATIENT UNDER THE CARE OF
DR. GUPTA AND FOR ASSESSMENT BY HIM

2. DEFENDANT TO REMAIN AN IN PATIENT AT WODEN VALLEY HOSPITAL DURING THE
PERIOD OF THE REMAND

3. DEFENDANT TO INFORM THE DIRECTOR OF PUBLIC PROSECUTIONS WHEN ASSESSMENT
BY DR. GUPTA IS COMPLETE

4. THAT THE DEFENDANT SURRENDER HIMSELF TO THIS COURT AT THE CONCLUSION OF
HIS ASSESSMENT

LIBERTY TO APPLY

DEFENDANT TO BE ESCORTED TO HOSPITAL BY AFP AND BROUGHT BACK TO COURT BY THE
AFP AT THE CONCLUSION OF THE ASSESSMENT

AND unless you appear accordingly and comply with these conditions the
recognizance entered into by you will forthwith be put in suit and enforced against
you.

DATED the day and year first
abovementioned at Canberra in
the Australian Capital Territory.

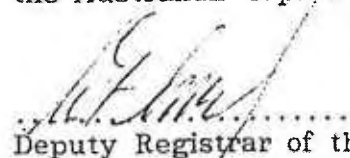
.....
Deputy Registrar of the Magistrates Court

100

437

**THIS PAGE HAS BEEN
INTENTIONALLY LEFT
BLANK**

138

WODEN VALLEY HOSPITAL

PATIENT PROGRESS

BAYLISS
Dr. GUPTA

WVH 608552
ALEXANDER
25/08/1970 M R/C S

7C MOORE HOUSE
O'CONNOR

IP HP MC 11
ACT 2611

Date & Time	Markov / ψ
21/9 1500	22 y.o. O.A. Admitted on a Court order until 25/9 pending a psychiatric + neuropsych. assessment.
	<u>HOPC</u>
	Nil past ψ Hx Doing 1st year Arts at ANU → involved in a 6 month long legal + libel debate regarding alleged sexual harassment by Alexander towards a Michelle Piercey.
	In summary, Michelle Piercey has alleged that Alexander has been telephoning her, harassing her by riding his bicycle around her, and threatening to kill her.
	Alexander went into considerable detail regarding each individual point about which she has charged him on, and this has no medical relevance.
	(I had the impression that Alex. was trying hard to present me with evidence about his innocence, however this was not relevant to my assessment)
	Alex was annoyed with the actions being brought against him, but in none of his speech did he display

PATIENT PROGRESS

51

S507 PA 12151(1/92)

Date & Time

features of a psychiatric illness
 this thought was logical + deliberate
 He displayed no particular malice
 to anyone
 - no homicidal or suicidal
 thoughts.

Past ψ Hx
 - nil

Personal Hx
 - from a family of
 high achievers
 - grew up in Victoria
 - performed well at school
 - had a longterm girlfriend
 btw 16 + 18 (lived w her)
 + has since concentrated on
 studies
 - involved in serious MVA
 age 15
 - unconscious for 3 weeks
 - no drug involvement

Family Hx
 1989 - both stepfathers parents
 committed suicide
 - no blood relatives c ψ illness.

Personality
 - Obsessional driven
 - describes self as outgoing
 + enterprising

1408

940

WODEN VALLEY HOSPITAL

BAYLISS
Dr. GUPTA

WMH 608552
ALEXANDER
25/08/1970 M R/C S

PATIENT PROGRESS

IP HP MC 11

7C MOORE HOUSE
O'CONNOR ACT 2611

Date & Time

Medical

MVA Dec. '85
→ apparently unconscious for
~~one~~ 3 weeks
→ at recovery
couldn't speak or walk
properly for several months
poor memory for the event

- under care of Dr. Danta.
He had seen a neuropsychologist,
Ursula Johns at that time.

BP 110/90 p 70 reg

CVS H₁th nil else

Resp chest clear - nil added,

Abdo lax, non-tender
○ megacolon

Neuro

tone }
power } (N) + symmetrical
reflexes }

sensⁿ }
coordⁿ } (N)

PATIENT PROGRESS

57

e & Time

frontal : some concrete thought
 "if they throw stones, they'll
 break their house or if you're
 in a fragile environment, be
 careful because it can be
 easily broken"

rolling stone gathers no moss
 "if you're always doing something, you're
 got no time to hang about"

Differences b/w oranges + tennis ball - OK
 sequencing (N)

Temporal orientation
 registration
 STM
 LTM } intact fully.

Parietal
 — dominant - intact
 non-dom - intact
 both : intact.

ABE MSE

1. well dressed in casual pants + jacket.
2. Affect - appropriate + responsive.
3. No perceptual disturbances
4. Thought stream - somewhat pressured
 firm - (N)
 content - appropriate.
5. Cognition intact.
6. Insight + judgement present

27A

142

WODEN VALLEY HOSPITAL

WH 608552

BAYLISS
Dr. GUPTA

ALEXANDER
25/08/1970 M R/C S

PATIENT PROGRESS

IP HP MC 11

7C MOORE HOUSE
O'CONNOR

ACT 2611

Date & Time	
21/9/92	1700 New admission to PSA under Dr Gupta as VOLUNTARY IT ON BAIL RECOGNIZANCE.
	- conditions of bail as follows
	i) - to be admitted under DR Gupta for assessment by him
	ii) to remain as an in-pt for period of remand
	iii) to inform the DIR. PUBLIC PROSECUTIONS when "assessment is complete"
	iv) to surrender himself to court at the conclusion of assessment and to be escorted to + from WVH by the Federal Police.
	Client charged with "CONTRAVENE RESTRAINING ORDER". Bail recognizance made in Magistrates Court today, charges is due to be heard on Friday, Sept 25th @ 1130hrs.
	Verbal instruction from both DR Gupta & DR Markou - that if MA Bayliss wishes to leave, no attempt be made to stop him, + that A.F.P be informed.
	Copy of Bail Recognizance is in plastic envelope at front of file.
	Present with nil overt evidence of mental illness/dysfunction.
	Relates in a clear fashion, with appropriate thought form + flow. Nil evidence of psychosis - no frank delusional ideation, no evidence of hallucinations.
	Alert, oriented, calm, mood appears euthymic, gives good account of himself,

PATIENT PROGRESS

52

SS07 PA H2151(1/92)

Date & Time

though when referring to his actions in relation to the person he has been allegedly harassing, he goes into copious, minute detail, as if it was a Police Interview. Seems to feel that he has been "set up" by this person, even though he acknowledges most of the alleged actions, + believes that the person making the accusations against him is a "versations litigant" - however, as it is difficult/impossible to verify his story, it is impossible to assess whether this ideation is delusional or not.

- Nil medication ordered.
- for Neuropsychiatric assessment
- for CT scan @ 1400 hrs tomorrow
- to fast from ~~0600~~¹⁰⁰⁰ light breakfast ordered.
- Urine Specimen taken for DRUG SCREEN.
- Will require continuing observation for any upcoming psychotic phenomena

MPR
RBN/RW

Addit. Has attempted to call home (to pick up messages on his answering machine - phone disconnected - seemed surprised by this, even though he admits that he owes Telecom \$1000!!

MPR
RBN/RW

1830hrs. Spent further 30/60 conversing c Alexander - seems quite grandiose in nature - for the following reasons
 - plans to appeal to the Supreme Court over this charge, + represent himself, + sees no possibility of failure. When I suggested (that he ever had) a hypothetical situation that he would fail, + his appeal be dismissed, his only comment was that this would then

WODEN VALLEY HOSPITAL

PATIENT PROGRESS

BAYLISS
Dr. GUPTA

944
WMH 608552
ALEXANDER
25/08/1970 M R/C S

7C MOORE HOUSE
O'CONNOR

ACT 2611

IP HP MC 11

Date & Time

be a denial of natural justice -
- his long term life goal is to be a lawyer, accountant, + several other jobs, rolled into one, + run a multinational advertising company, has multiple ideas on this one, but no apparent concrete plans to actually achieve it.
- has little emotional response to any of the stressors he is under, + little if any fear of the consequences - in fact, he seems blasé. (His mother conf. made a point of this)
Mother contacted to inform her that Alex is in hospital.
She stressed that the approach that she + Alex's stepfather were taking was that of a supportive nature, but that they would take no measures to "rescue" him from the consequences of his actions. Also informed me that Alex has always been unable to envision consequences to his actions, + has gone to outlandish lengths to (~~manipulate~~ ~~error~~ avoid suffering them). She described him as highly manipulative in this respect. Gave, as an example, a situation where he borrowed a Volvo, drove to Goulburn, dropped into the Police station, then requested that they sign a document to prove that he was in Goulburn at this time.

PATIENT PROGRESS

51

148

245

& Time

then returned to Canberra, dropped in to AF Police, to ask if there were any warrants for his arrest. Apparently during the period, Michelle Piercey received a harassing phone call. Alex used this to defend himself in a court hearing.

Mother
Rita

dit Mother will fax another Neuropsychology report (completed after the MVA) tomorrow. Also informed me that in her opinion, his academic performance improved post MVA.

dit - Has previously been treated by Dr Type, or at least he has a copy of the Neuropsych report.

25th 21/9/92 P/C from CONST. PUGH (AFP CIVIC) enquiring as to whether Alex has had access to an outgoing phone tonight, as Ms Piercey had received (allegedly) another threatening phone call from Alex, initially introduced by another male voice. Informed him that all calls had been made by myself, then connected to the pt's phone, + that Alex had recorded all phone no's dialled, + that the number concerned had not been dialled by myself or other staff. Requested that Ms Piercey, (who was at the Police Station at the time) not be informed by him that Alex was an in-pt in the interests of pt confidentiality. Further check of Alex's record of numbers confirmed that the said number had not been dialled. When I

FPA

446

WODEN VALLEY HOSPITAL

WMH 608552
ALEXANDER
25/08/1970 M R/C S

PATIENT PROGRESS

BAYLISS
Dr. GUPTA

IP HP MC 11

7C MOORE HOUSE
O'CONNOR

ACT 2611

Date & Time	
	<p>informed Alex (that he knew me) of what had occurred, he was delighted, in that, in his viewpoint, this only (went to one) seemed to prove that he was being "set up". Requested that I call AEP so he could talk to CONST PUGH, which I did, but the number was constantly engaged.</p>
<p>21.9.92 2230</p>	<p>after the police came to check that Alexander Bayliss was secure in the acute unit I informed him that he was required to hand in his clothing or be detained in the high dependency unit. I informed him that being placed in pyjamas was part of an admission, when there was a fear of absconding. <i>Chf (RM)</i></p>
<p>21.9.92</p>	<p>Soon after the evening staff</p>
<p>24.00</p>	<p>departed, Alexander came to the nursing and requested to see his files. He began to give a description of his bail etc as a reason for needing to see his files. It was explained that he would need to talk this over with his doctor. He was very alert + looked as if he was going to spend the night</p>

PATIENT PROGRESS

52

S507 PA 1215 (1/1972)

Date & Time

awake - He started a game of chess with his roommate, + was happily sitting on his bed drinking tea + eating biscuits - Night sedation was ordered by Dr. Fudge. P. Alexander would not take the sedation until he had written down the doctor's name who had ordered the sedation - He said he was a 'night person' + often slept during the day. Staff explained that in hospital this was not appropriate and that it could be disturbing to other patients - S. Eaton Mr. O'Keefe
 After sedation @ 2400, Alexander slept for the remainder of the night.
 S. Eaton Mr.

NEUROPSYCHOLOGY

20/9/92
 12:15

Many thanks for referring Alex for NCF review, which was commenced this am.
 Pls: Review starting 15:00 this afternoon.
 Thanks for

21/9/92

148

WVH 608552
ALEXANDER
25/08/1970 M R/C S

date of admission: 21/9/92

psychiatrist... G. GUPTA.....

7C MOORE HOUSE
O'CONNOR ACT 2611
IP HP MC 11

PK
ETIOLOGY (evidenced by)
SIGNS & SYMPTOMS
(defining characteristics)

OBJECTIVES
(short & long term)

NURSING INTERVENTIONS

EVALUATION

SIGN
DATE

1. Client admitted on bail recognizance or assessment. No Medical Diagnosis made on admission.

S.1. Thorough assessment of client for any symptomatology of mental illness/depression
ii) client to be aware of responsible for keeping to conditions of bail (see document in notes)

- On going observation + assessment
- Attempt to build trust + rapport + client in the hope that he will open up + divulge any beliefs that are psychotic. (if there are occurring!)
- client to be treated as vol pt., however, police to be notified if he leaves premises
- client to be made aware of conditions of bail, as related to his status as a vol. pt.

2. Possible self esteem disturbance - overvalued idea of self or self capabilities aetiology uncertain - evidenced by plans to conduct own supreme court challenge

- assess as to whether his ideas of self are actually grandiose or not

- continual observation
- assessment + interaction.

848

849

THIS PAGE HAS BEEN
INTENTIONALLY LEFT
BLANK

WISCONSIN CARD SORTING TEST SCORING AND RECORDING FORM

Robert Heaton, Ph.D.
University of Colorado School of Medicine

NAME A. BAYLISS AGE _____ SEX _____

EDUCATION _____ OCCUPATION _____

BEHAVIOR DURING TESTING _____

ADDITIONAL COMMENTS _____ 23/9

Trials: C, F, N, C, F, N,

CFNO	CFNO	CFNO	CFNO	CFNO	CFNO	CFNO
CFNO	CFNO	CFNO	CFNO	CFNO	CFNO	CFNO
CFNO	CFNO	CFNO	CFNO	CFNO	CFNO	CFNO
CFNO	CFNO	CFNO	CFNO	CFNO	CFNO	CFNO
CFNO	CFNO	CFNO	CFNO	CFNO	CFNO	CFNO
CFNO	CFNO	CFNO	CFNO	CFNO	CFNO	CFNO
CFNO	CFNO	CFNO	CFNO	CFNO	CFNO	CFNO
CFNO	CFNO	CFNO	CFNO	CFNO	CFNO	CFNO
CFNO	CFNO	CFNO	CFNO	CFNO	CFNO	CFNO
CFNO	CFNO	CFNO	CFNO	CFNO	CFNO	CFNO
CFNO	CFNO	CFNO	CFNO	CFNO	CFNO	CFNO
CFNO	CFNO	CFNO	CFNO	CFNO	CFNO	CFNO
CFNO	CFNO	CFNO	CFNO	CFNO	CFNO	CFNO
CFNO	CFNO	CFNO	CFNO	CFNO	CFNO	CFNO
CFNO	CFNO	CFNO	CFNO	CFNO	CFNO	CFNO
CFNO	CFNO	CFNO	CFNO	CFNO	CFNO	CFNO
CFNO	CFNO	CFNO	CFNO	CFNO	CFNO	CFNO
CFNO	CFNO	CFNO	CFNO	CFNO	CFNO	CFNO
CFNO	CFNO	CFNO	CFNO	CFNO	CFNO	CFNO
CFNO	CFNO	CFNO	CFNO	CFNO	CFNO	CFNO
CFNO	CFNO	CFNO	CFNO	CFNO	CFNO	CFNO

CORRECT 55 ERRORS 9 PERSEVERATIVE RESPONSES 4

NONPERSEVERATIVE ERRORS 5 PERSEVERATIVE ERRORS 4 CATEGORIES 4

Copyright © 1981 Psychological Assessment Resources, Inc. All Rights Reserved. Not to be reproduced by any means.

FORM #307-SF

3 ways to be started Stage, No, Col.

acc you had condition

Trials to 1st error 11

% conceptual level = 79.7%

No persever

% perseverative errors = 6.2%

७७६

१५१

**THIS PAGE HAS BEEN
INTENTIONALLY LEFT
BLANK**

by Sarah Jastak and Gary S. Wilkinson

Name _____ Sex: M. F.

Date _____ Birth Date _____ Age _____

School _____ Grade _____

Referred by _____ Examiner _____

Ages 12 yrs. 0 mo. to 75 yrs.

Spelling, Level 2

Test Results:	Raw Score	Standard Score	Percentile	Grade Equivalents
Reading	_____	_____	_____	_____
Spelling	_____	_____	_____	_____
Arithmetic	_____	_____	_____	_____

Use only standard scores for comparisons

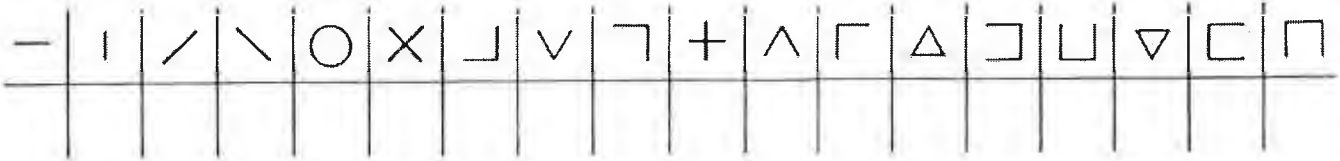

Name _____
(cumulative score: 1 letter = 4, 2 letters = 5)

cumulative score copying: score 4-9 = 1 point
score 10-17 = 2 pts. score all 18 = 3 pts.

- 1. _____ 16. _____ 31. _____
- 2. _____ 17. _____ 32. _____
- 3. _____ 18. _____ 33. _____
- 4. _____ 19. _____ 34. _____
- 5. _____ 20. _____ 35. _____
- 6. _____ 21. _____ 36. _____
- 7. _____ 22. _____ 37. _____
- 8. _____ 23. _____ 38. _____
- 9. _____ 24. _____ 39. _____
- 10. _____ 25. _____ 40. _____
- 11. _____ 26. _____ 41. _____
- 12. _____ 27. _____ 42. _____
- 13. _____ 28. _____ 43. _____
- 14. _____ 29. _____ 44. _____
- 15. _____ 30. _____ 45. _____
- _____ 46. _____

WIDE RANGE ACHIEVEMENT TEST • REVISED LEVEL 2

Page 2

Arithmetic, Oral Part

854

17

21

9

9

8

- 1. Counts 1-5
- 6. Reads 17

- 2. Counts 6-15
- 7. Reads 41

- 3. Reads 3
- 8. Pennies 3-1

- 4. Reads 5
- 9. Apples 3 + 4

- 5. Reads 6
- 10. Marbles 9-3

Arithmetic, Written Part

$2 + 7 = \underline{9}$
 $8 - 4 = \underline{4}$

$$\begin{array}{r} 43 \\ + 6 \\ \hline 49 \end{array}$$

$$\begin{array}{r} 73 \\ + 9 \\ \hline 82 \end{array}$$

$$\begin{array}{r} 36 \\ - 15 \\ \hline 21 \end{array}$$

$$\begin{array}{r} 94 \\ - 64 \\ \hline 30 \end{array}$$

$3 \times 4 = \underline{12}$

$18 \div 6 = \underline{12}$

$$\begin{array}{r} 512 \\ \times 3 \\ \hline \end{array}$$

$$\begin{array}{r} 1536 \end{array}$$

$$\begin{array}{r} \$4.95 \\ \times 3 \\ \hline \end{array}$$

14.85

$$\begin{array}{r} 726 \\ - 349 \\ \hline \end{array}$$

$4\frac{1}{3} + 3 = \underline{\hspace{2cm}}$

$2\frac{1}{2} + 1\frac{1}{2} = \underline{\hspace{2cm}}$

$\frac{1}{2}$ of 18 =

$\frac{1}{6}$ of 30 =

$$\begin{array}{r} 229 \\ 504 \\ 63 \\ \hline \end{array}$$

$$\begin{array}{r} + 1381 \end{array}$$

$$5 \overline{) 215}$$

$$9 \overline{) 4527}$$

$1\frac{1}{3}$ ft. = in.

$2 - \underline{\hspace{1cm}} = \frac{1}{4}$

Add: $6\frac{1}{4}$
 $1\frac{5}{8}$
 $4\frac{1}{2}$

$$\begin{array}{r} 809 \\ \times 47 \\ \hline \end{array}$$

Write as percent:
 $.42 = \underline{\hspace{1cm}}\%$

Subtract:
 $10\frac{1}{4}$
 $7\frac{2}{3}$

Multiply: $\begin{array}{r} 6.23 \\ 12.7 \end{array}$

Find average:
 34, 16, 45, 39, 27
 Ans.

Write as decimal:
 $52\frac{1}{2}\% = \underline{\hspace{1cm}}$
 Write as percent:
 $\frac{3}{8} = \underline{\hspace{1cm}}\%$

$$2.9 \overline{) 308.85}$$

Add: 3 ft. 6 in.
 5 ft. 5 in.
8 ft. 11 in.

$M + 2 = 5$
 $M = \underline{\hspace{1cm}}$

$2x = 3$
 $x = \underline{\hspace{1cm}}$

$6 \times 3\frac{7}{8} = \underline{\hspace{2cm}}$

15% of 175 =
 17.5 $10^{\circ}/10$
 875 = ~~50~~ **Go to Next Page**

255

Write as common fraction
in lowest terms: $.075 =$ _____

The complement of
an angle of $30^\circ =$ _____

$4^3 =$ _____ If $a = 7, b = 3;$ $\frac{1}{4}\%$ of 60 = _____
 $.25 \div 1\frac{1}{5} =$ _____ $a^2 + 3b =$ _____ 66 sq. ft. = _____ sq. yd. Solve:
 $\frac{7 - (6 + 8)}{2} =$ _____

Add: Factor: $\frac{r^2 - 5r - 6}{r + 1}$ Change to familiar numerals:
 $\begin{array}{r} x - y - 23 \\ x - y + 22 \end{array}$ $r^2 + 25 - 10r$ M D C X C I = _____
 Ans. _____ Ans. _____ Find interest on \$1,200 at 6%
 for 70 days. Ans. _____

$3p - q = 10$ $\sqrt{2ax} = 6$ Find square root:
 $2p - q = 7$ $x =$ _____ $\sqrt{67081}$
 $p =$ _____
 $q =$ _____
 $\frac{7}{17} = \frac{6}{x}$
 $x =$ _____

$\log_{10} \left(\frac{1}{100}\right)$ $\log_5 5\sqrt{5}$ Reduce: Find root:
 Ans. _____ Ans. _____ $\frac{k^2 + k}{k^2} \cdot \frac{3k - 3}{k^2 - 1}$ $2x^2 - 36x = 162$
 Ans. _____ Ans. _____

WIDE RANGE ACHIEVEMENT TEST • REVISED LEVEL 2

Page 4

Reading, Level 2

956

Two letters in name (2)

A B O S E R T H P I U Z Q

milk	city	in	tree	animal	himself	between	chin	split	24
form	grunt	stretch	theory	contagious	grieve	toughen	aboard		32
triumph	contemporary	escape	eliminate	tranquillity	conspiracy				38
image	ethics	deny	rancid	humiliate	bibliography	unanimous			45
predatory	alcove	scald	mosaic	municipal	decisive	contemptuous			51
deteriorate	stratagem	benign	desolate	protuberance	prevalence				58
regime	irascible	peculiarity	pugilist	enigmatic	predilection				64
covetousness	soliloquize	longevity	abysmal	ingratiating	oligarchy				70
coercion	vehemence	sepulcher	emaciated	evanescence	centrifugal				77
subtlety	beatify	succinct	regicidal	schism	ebullience	misogyny			83
beneficent	desuetude	egregious	heinous	internecine	synecdoche				89

COPYRIGHT 1984 by Jastak Associates, Inc., 1526 Gilpin Avenue, Wilmington, Delaware 19806
All rights reserved. Printed in U.S.A. 1937, 1946, 1965, 1976, 1978, 1984

Photocopying of this test is a violation of copyright law.

WRAT-R²

Raw Score to Grade Equivalents

JASTAK
ASSESSMENT NEWS

READING		Raw Score to Grade Equivalents																		SEM = 2				
RS	1-30	35	40	45	50	55	60											65-89						
GE	Below 3	3B	3E	4B	4E	5B	5E	6B	6E	7B	7E	8B	8E	9B	9E	10B	10E	11B	11E	12B	12E	Above 12		
SEM = 2																								
SPELLING																								
RS	1-10	15	20	25	30	35																36-51		
GE	Below 3	3B	3E	4B	4E	5B	5E	6B	6E	7B	7E	8B	8E	9B	9E	10B	10E	11B	11E	12B	12E	Above 12		
SEM = 2																								
ARITHMETIC																								
RS	1-14	15	20	25	30	35																40-66		
GE	Below 3	3B	3E	4B	4E	5B	5E	6B	6E	7B	7E	8B	8E	9B	9E	10B	10E	11B	11E	12B	12E	Above 12		
SEM = 2																								

NAME: 157
 Date: _____
 Score: _____ Rec: _____

SCORE SHEET FOR REY-OSTERRIETH COMPLEX FIGURE TEST

Copy: Recall: Units:

- | | | |
|-----------|-------------|--|
| 2 ① 1 ½ 0 | 2 ① 1 ½ 0 | 1. Cross upper left corner, outside of rectangle |
| ② 1 1 ½ 0 | ② 1 1 ½ 0 | 2. Large rectangle |
| ② 1 1 ½ 0 | ② 1 1 ½ 0 | 3. Diagonal cross |
| ② 1 1 ½ 0 | ② 1 1 ½ 0 | 4. Horizontal midline of 2 |
| ② 1 1 ½ 0 | ② 1 1 ½ 0 | 5. Vertical midline |
| ② 1 1 ½ 0 | 2 1 1 ① ½ 0 | 6. Small rectangle, within 2 to the left |
| ② 1 1 ½ 0 | ② 1 1 ½ 0 | 7. Small segment above 6 |
| 2 ① 1 ½ 0 | ② 1 1 ½ 0 | 8. Four parallel lines within 2, upper left |
| ② 1 1 ½ 0 | 2 1 1 ① ½ 0 | 9. Triangle above 2 upper right |
| ② 1 1 ½ 0 | 2 1 1 ① ½ 0 | 10. Small vertical line within 2, below 9 |
| ② 1 1 ½ 0 | ② 1 1 ½ 0 | 11. Circle with three dots within 2 |
| ② 1 1 ½ 0 | 2 1 1 ① ½ 0 | 12. Five parallel lines with 2 crossing 3, lower right |
| ② 1 1 ½ 0 | ② 1 1 ½ 0 | 13. Sides of triangle attached to 2 on right |
| 2 ① 1 ½ 0 | ② 1 1 ½ 0 | 14. Diamond attached to 13 |
| ② 1 1 ½ 0 | 2 ① 1 ½ 0 | 15. Vertical line within triangle 13 parallel to right verti |
| ② 1 1 ½ 0 | 2 ① 1 ½ 0 | 16. Horizontal line within 13, continuing 4 to right |
| ② 1 1 ½ 0 | 2 ① 1 ½ 0 | 17. Cross attached to low center |
| ② 1 1 ½ 0 | ② 1 1 ½ 0 | 18. Square attached to 2, lower left |

AS REC IN MRD

Score: 33 Score: 24 1/2

SCORING:

Consider each of the eighteen units separately. Appraise accuracy of each unit and its position within the whole of the design. For each unit count as follows:

Correct	}	placed properly	2 points
		placed poorly	1 point
Distorted or incomplete but recognizable	}	placed properly	1 point
		placed poorly	½ point
Absent or not recognizable			0 points
Maximum			36 points

228

278

**THIS PAGE HAS BEEN
INTENTIONALLY LEFT
BLANK**

۵۸

۲۹۹

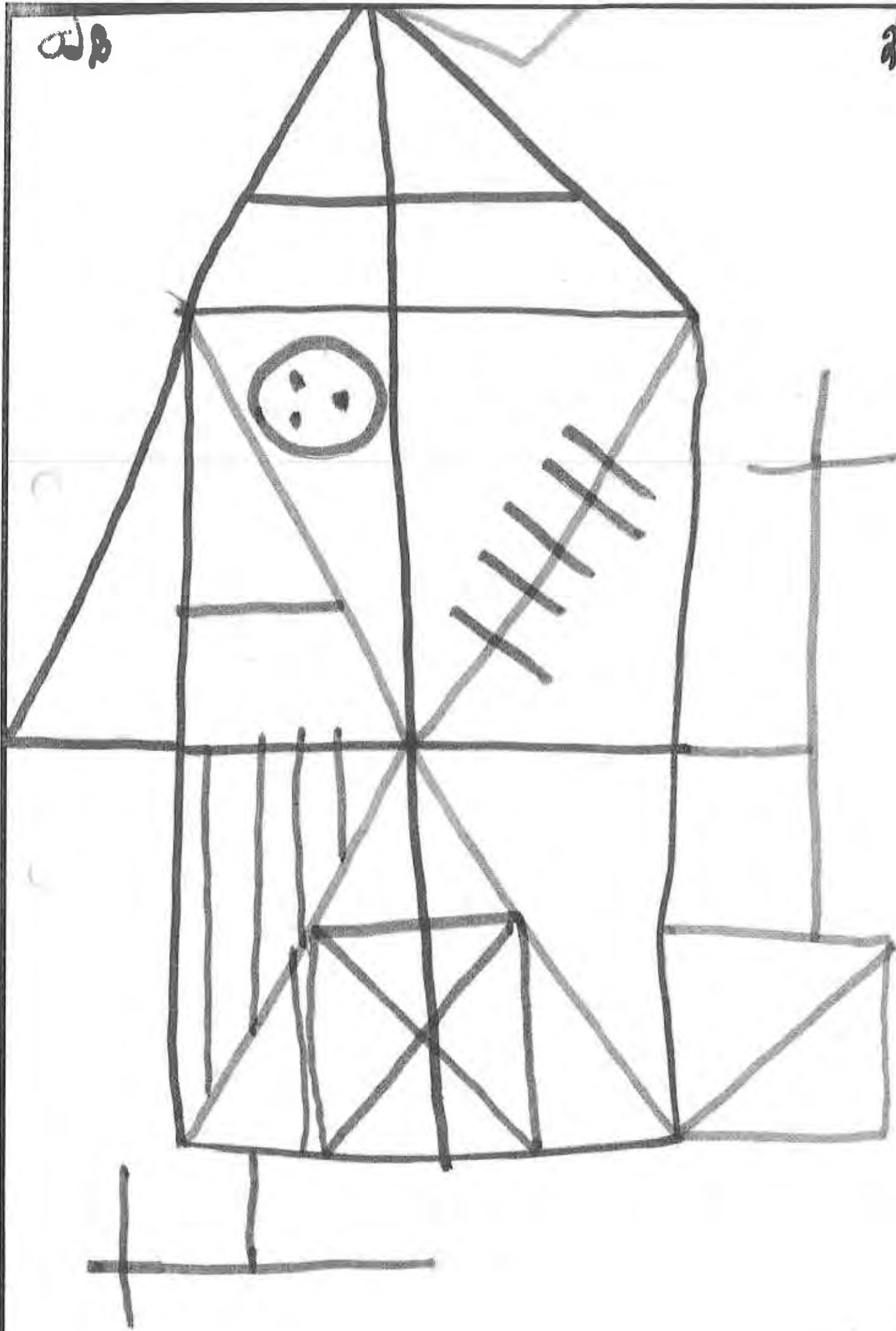

PRR

960

**THIS PAGE HAS BEEN
INTENTIONALLY LEFT
BLANK**

60/6

261

4' delay

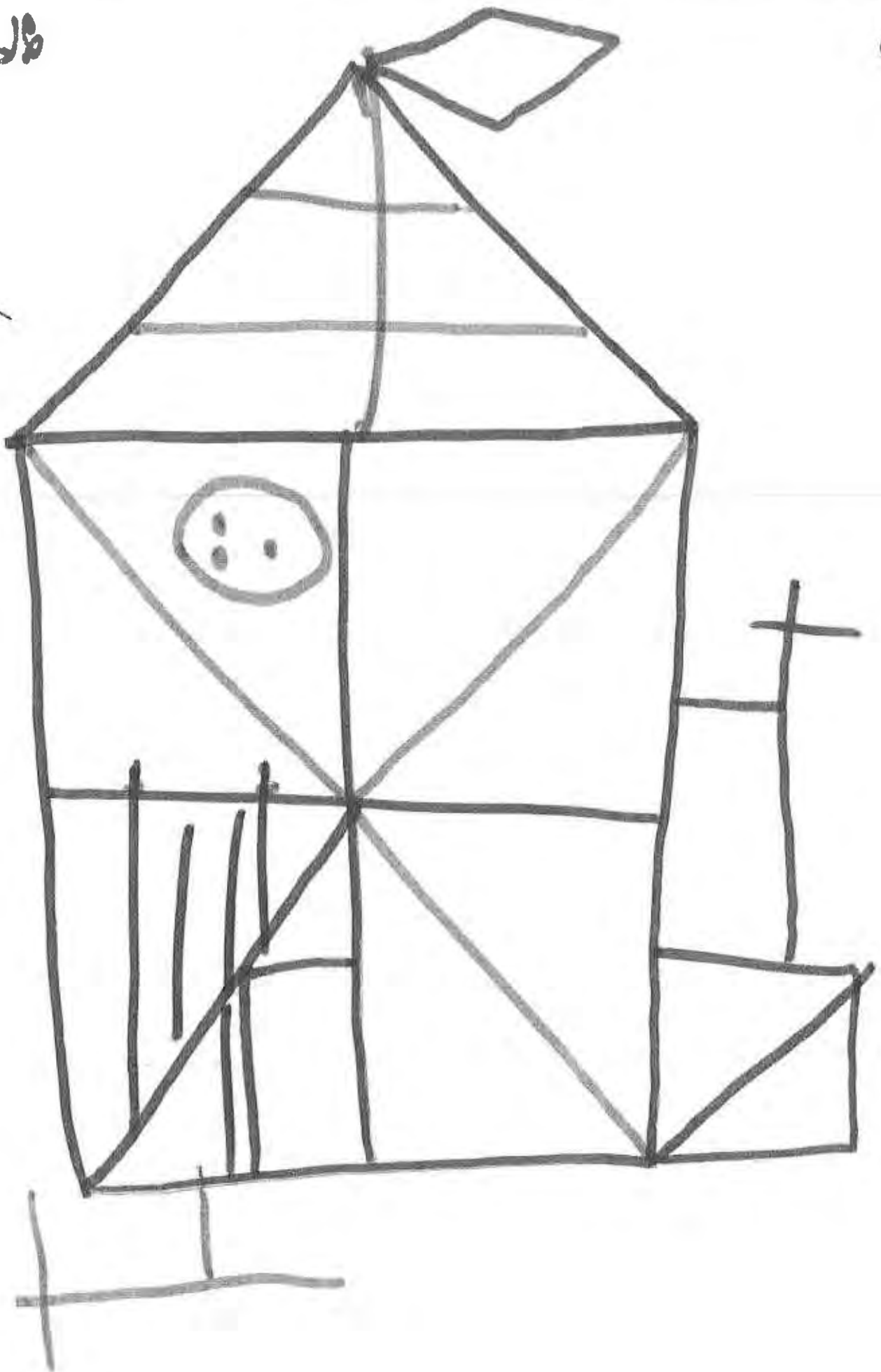

amazing
accusate
attentive
(attentive)
abude

agonizing
amput

alphabet
(Arabic)

augment
away

Arabic no thais
not fig

ariola
(Arabella)

pat
plying
petching
flung
flap

fling
flipped
failing
(fetching)
(far)

fingers
fasting

found
find

fixed
(fetal)

fog
flint
forgotte

superst

snake

slippery

slimy

slurred

(slimed)

slip

slap

standards

slithering

slipper

stoe

still

stake

stilts

siphan

(slip)

(slipway)

super

slow

sluggish

slapped

sugar

WAIS-R RECORD FORM

863

WECHSLER ADULT
INTELLIGENCE SCALE—
REVISED

NAME Alex BAYLISS

ADDRESS _____

AUSTRALIAN ADAPTATION

SEX _____ AGE _____ MARITAL STATUS _____

OCCUPATION _____ EDUCATION _____

COUNTRY OF BIRTH _____ FIRST LANGUAGE _____

PLACE OF TESTING _____ TESTED BY _____

OTHER INFORMATION _____

TABLE OF SCALED SCORE EQUIVALENTS*

Scaled Score	RAW SCORE											Scaled Score
	VERBAL TESTS						PERFORMANCE TESTS					
	Information	Digit Span	Vocabulary	Arithmetic	Comprehension	Similarities	Picture Completion	Picture Arrangement	Block Design	Object Assembly	Digit Symbol	
19	—	28	70	—	32	—	—	—	51	—	93	19
18	29	27	69	—	31	28	—	—	—	41	91-92	18
17	—	26	68	19	—	—	20	20	57	—	89-90	17
16	28	25	66-67	—	30	27	—	—	49	40	84-88	16
15	27	24	65	18	29	26	—	19	47-48	39	79-83	15
14	26	22-23	63-64	17	27-28	25	19	—	44-46	38	75-78	14
13	25	20-21	60-62	16	26	24	—	18	42-43	37	70-74	13
12	23-24	18-19	55-59	15	25	23	18	17	38-41	35-36	66-69	12
11	22	17	52-54	13-14	23-24	22	17	15-16	35-37	34	62-65	11
10	19-21	15-16	47-51	12	21-22	20-21	16	14	31-34	32-33	57-61	10
9	17-18	14	43-46	11	19-20	18-19	15	13	27-30	30-31	53-56	9
8	15-16	12-13	37-42	10	17-18	16-17	14	11-12	23-26	28-29	48-52	8
7	13-14	11	29-36	8-9	14-16	14-15	13	8-10	20-22	24-27	44-47	7
6	9-12	9-10	20-28	6-7	11-13	11-13	11-12	5-7	14-19	21-23	37-43	6
5	6-8	8	14-19	5	8-10	7-10	8-10	3-4	8-13	16-20	30-36	5
4	5	7	11-13	4	6-7	5-6	5-7	2	3-7	13-15	23-29	4
3	4	6	9-10	3	4-5	2-4	3-4	—	2	9-12	16-22	3
2	3	3-5	6-8	1-2	2-3	1	2	1	1	6-8	8-15	2
1	0-2	0-2	0-5	0	0-1	0	0-1	0	0	0-5	0-7	1

	Year	Month	Day
Date Tested	92	9	23
Date of Birth	70	8	25
Age	22		

SUMMARY		
	Raw Score	Scaled Score
VERBAL TESTS		
Information	23	12
Digit Span	—	—
Vocabulary	54	11
Arithmetic	13	11
Comprehension	26	11
Similarities	21	10
Verbal Score	55	66
PERFORMANCE TESTS		
Picture Completion	16	10
Picture Arrangement	18	13
Block Design	50	17
Object Assembly	14	15
Digit Symbol	51	8
Performance Score	40	60

	Sum of Scaled Scores	10
VERBAL	66	107 U.S.
PERFORMANCE	60	114
FULL SCALE	126	111

*Clinicians who wish to draw a profile may do so by locating the subject's raw scores on the table above and drawing a line to connect them. See Chapter 4 in the Manual for a discussion of the significance of differences between scores on the tests

3/2

264

1. INFORMATION

Discontinue after 5 consecutive failures.

Score
1 or 0

START →

1. Flag		
2. Ball		
3. Months		
4. Thermometer		
5. Sun	E	1
6. Ned Kelly	hustler,	1
7. Weeks	52	1
8. Bradman	famous cricket player in Aust	1
9. Darwin-Adelaide	down SK	1
10. Hamlet	Shakespeare	1
11. Italy	Venice etc	1
12. Population	17m	1
13. Brazil	S th America	1
14. PM England	W. Churchill	1
15. Australia Day	Feb	0
16. Sahara	Africa	1
17. Clothes	they attract more sunlight	0
18. Kingsford-Smith	famous aviator	1
19. Genesis	DK about life or genetics 1 DK	0
20. Four PMs	Holt, Whitlam, Fraser, Hawke	1
21. Martin L. King	Guy in USA, activist of some sort - black rights activist	1
22. Relativity	Einstein	1
23. Boiling Point	100°C	1
24. Yeast	it grows @...temp, rises at a certain temperature	0
25. Blood vessels	arteries, veins, capillaries	1
26. Curie	an experiment with radium radioactivity	0
27. London-Sydney	15,000km	1
28. Koran	name for a Bible, for in a different religion - DK which	0
29. Faust	DK.	0

Note: Be sure to include scores for items 1-4 in Total

Max=29
Total 23

965

2. PICTURE COMPLETION		Score	Score	
Discontinue after 5 consecutive failures.		1 or 0	1 or 0	
1. Door		/	11. Mirror	/
2. Tennis		/	12. Crab	/
3. Frog		/	13. Violin	/
4. Playing card		/	14. Sun	/
5. Car		/	15. Watch	/
6. Pitcher		/	16. Leaf <i>wrong vein</i>	0
7. Glasses		/	17. Man <i>shirt pocket</i> @ <i>s.e.</i>	1
8. Pliers		/	18. Horse <i>reigns, stirrups</i> @ <i>t.</i>	0
9. Boat		/	19. Female profile	1
10. Beach <i>of correct</i>	0		20. Woodpile <i>windows on upper level</i> <i>artificial hoarding</i>	0
			Total	16
				Max=20

3. DIGIT SPAN Discontinue after failure on BOTH TRIALS of any item. Administer BOTH TRIALS of each item, even if subject passes first trial.

DIGITS FORWARD		Pass-Fail	Score 2, 1, or 0	DIGITS BACKWARD *		Pass-Fail	Score 2, 1, or 0
1.	5-8-2			1.	2-4		
	6-9-4				5-8		
2.	6-4-3-9			2.	6-2-9		
	7-2-8-6				4-1-5		
3.	4-2-7-3-1			3.	3-2-7-9		
	7-5-8-3-6				4-9-6-8		
4.	6-1-9-4-7-3			4.	1-5-2-8-6		
	3-9-2-4-8-7				6-1-8-4-3		
5.	5-9-1-7-4-2-8			5.	5-3-9-4-1-8		
	4-1-7-9-3-8-6				7-2-4-8-5-6		
6.	5-8-1-9-2-6-4-7			6.	8-1-2-9-3-6-5		
	3-8-2-9-5-1-7-4				4-7-3-9-1-2-8		
7.	2-7-5-8-6-2-5-8-4			7.	9-4-3-7-6-2-5-8		
	7-1-3-9-4-2-5-6-8				7-2-8-1-9-6-5-3		
Total Forward			Max=14	Total Backward			Max=14

*Administer DIGITS BACKWARD even if subject scores 0 on DIGITS FORWARD.

	+		=		=	
Forward		Backward		Total		Max=28

all

PICTURE ARRANGEMENT Discontinue after 4 consecutive failures beginning with Item 2.

Arrangement	Order	Correct or Acceptable Order	Score (Circle)	Arrangement	Order	Correct or Acceptable Order	Score (Circle)	
1. House 60"	1 2	CAP	0 1 2	6. Escape 90"		HUNT	0 2	
2. Flirt 60"		JANET JNAET or AJNET	0 1 2	7. Hill 90"		HELPS	0 2	
3. Romeo 60"		SHADE	0 2	8. Fish 90"		ANGLER or ARNGLE AGNLER	0 1 2	
4. Louie 60"		ARGUES	0 2	9. Robber 120"		LUNCH	0 2	
5. Enter 90"	28"	OPENS OENSP	0 1 2	10. Taxi 120"		SAMUEL or AMUELS SALMUE	0 1 2	
							Total	Max-20 18

Note: Be sure to include scores for items 1-5 in Total.

5. VOCABULARY Discontinue after 5 consecutive failures. Score 2, 1, or 0

START →

1. Bed								
2. Ship								
3. Penny								
4. Winter	season, when it's cold, animals hibernate	2						
5. Breakfast	food we eat at br. time, 1st meal of the day	2						
6. Repair	when you fix something	2						
7. Fabric	material @ production of materials used, woven	1						
8. Assemble	to put something together	2						
9. Enormous	v. large	2						
10. Conceal	when you disguise, hide something	2						
11. Sentence	a construction of words about a specific topic, in a coherent way							
12. Consume	to use, like consume 100 of petrol	2						
13. Regulate	there are regulations that involve furniture, safety, guidelines	1						
14. Terminate	to come to an end	2						
15. Commence	beginning of something	2						
16. Domestic	of or relating to the home	2						
17. Tranquil	peaceful, quiet	2						
18. Ponder	wondering, thinking	2						
19. Designate	give it a label, put something in a place, allocate	2						
20. Reluctant	hesitant	2						
21. Obstruct	when you impede a person from doing something, prevent	2						
22. Sanctuary	environment where it is peaceful & harmonious for whatever	1						
23. Compassion	sympathy understanding, concern of the suffering	2						
24. Evasive	avoid answering questions, dissembling, avoid	1						
25. Remorse	one who is sorry that they've done (bad) things & don't want to do it	2						
26. Perimeter	distance around	2						
27. Generate	the making of sth. electricity, generate water power	1						
28. Matchless	when there is not a pair	0						
29. Fortitude	strength @ great courage to stand up for your beliefs	2						
30. Tangible	something you can touch	2						
31. Plagiarize	when you write something & copy someone else's work w/ recognition, proof of authorship	2						
32. Ominous	apparently obvious	0						
33. Encumber	the act of making it inconvenient - God of the day in power	0						
34. Audacious	relating to auditory system, someone who speaks a lot & loudly	0						
35. Tirade	one of a series of angry remarks & expressions, stimulate the auditory system	0						
							Total	Max-70 54

Note: Be sure to include scores for items 1-3 in Total.

267

6. BLOCK DESIGN Discontinue after 3 consecutive failures.

Design	Time	Pass-Fail	Score					
			(Circle the appropriate score for each design.)					
1. 60"	1 4"	P				(2)		
	2		0	1				
2. 60"	1 3"	P				(2)		
	2		0	1				
3. 60"	4"	P	0		16-60 4	11-15 5	(1-10) 6	
4. 60"	5"	P	0		16-60 4	11-15 5	(1-10) 6	
5. 60"	7"	P	0		21-60 4	16-20 5	11-15 6	(1-10) 7
6. 120"	18"	P	0		36-120 4	26-35 5	21-25 6	(1-20) 7
7. 120"	27"	P	0		61-120 4	46-60 5	31-45 6	(1-30) 7
8. 120"	24"	P	0		76-120 4	56-75 5	41-55 6	(1-40) 7
9. 120"	43"	P	0		76-120 4	56-75 5	(41-55) 6	1-40 7
						Max=51		
						Total	50	

Block Designs: Sketch incorrect solutions offered by the examinee.

1. 2. 3. 4. 5. 6. 7. 8. 9.

7. ARITHMETIC Discontinue after 4 consecutive failures.

Problem	Response	Score 1 or 0	Problem	Response	Time	Score (Circle)
1. 15"			10. 60"	65 km	40"	0 (11-60) 1
2. 15"			11. 60"	\$1.86	12"	0 (11-60) 1
3. 15"	\$9	1	12. 60"	\$600	1"	0 11-60 1 (1-10) 2
4. 15"	\$4	1	13. 60"	\$51	26"	0 16-60 1 1-15 2
5. 30"	\$1.50	1	14. 120"	72 ^c 144	35"	0 (16-120) 1 1-15 2
6. 30"	6	1			Max=19	
7. 30"	8	1			Total	13
8. 30"	36	1				
9. 30"	\$11.50 s.c	1				

START →

Note: Be sure to include scores for items 1-9 in Total.

8. OBJECT ASSEMBLY Give entire test to all subjects.

Object	Time	Score (Circle appropriate score for each object.)												
		0	1	2	3	4	5	6	7	8	9	10	11	12
1. Manikin 120"														
2. Profile 120"														
3. Hand 180"														
4. Elephant 180"														
Total												Max=41		

Object Assembly: For incomplete solutions, circle each X representing a connection for which the examinee receives credit.

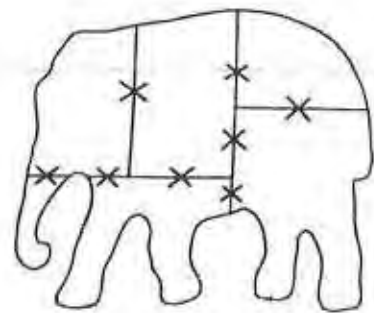
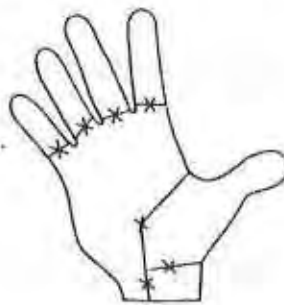
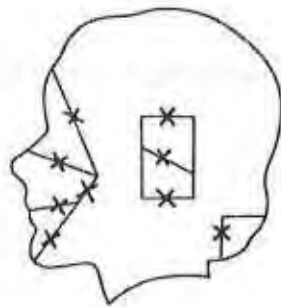
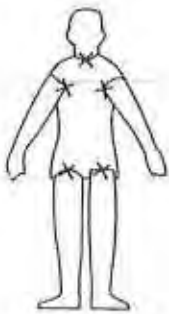

878

967

9. COMPREHENSION		Discontinue after 4 consecutive failures.	Score 2, 1, or 0
1. Clothes	No clean men		2
2. Envelope	put it in the post box		2
*3. Foods	Can't be eaten when not cooked is not edible when raw & it's clean, otherwise it's not so easily digested		2
*4. Child employment	They'd be exploited & they should be at school, studying		2
5. Deaf	They can never hear & if you can't hear how others speak how can you hear - add another or others		2
6. Borrow	Can lose friendship if there are probs. Friend would feel exploited, place stress on relationship		1
7. Pictures	Go to relevant people who work there & inform the, inform standards		2
8. Marriages	It's a legal agreement in your spouse, therefore different rights. B/c it's a legally binding contract		1
9. Taxes	Can pay for what state provides - roads, transport, regulations, hospitals. Govt receives on income via tax revenue		2
10. Forest	Follow directions in which the trees are set. Work and bearing go in direction that leads to it.		2
11. Prescription	Medics are dangerous unless prescribed, they are for different & medical reasons.		2
12. Iron	Take your opportunity while it's there		2
13. Land	Land prices high, more competition to live in city for people, investment > demand.		1
14. Brooks	one who says a lot doesn't know much. One who is always speaking doesn't know.		1
15. Swallow	Just because there is a swallow it doesn't mean it's summer - need a plethora of swallows		0
16. Press	They get out the issues they want. Can be used as a manipulative tool to & trick people etc.		0.
<p>* If the subject replies with only one idea, ask for a second response. Rephrase the test item appropriately, saying, "Tell me another reason why..."</p> <p>Provides leverage for the people</p>			<p>Max=32</p> <p>Total</p> <p>24</p>

87

9	2	8	1	7	9	4	6	8	5	9	7	1	8	5	2	9	4	8	6	3	7	9	8	
6	2	5	1	9	2	8	3	7	4	6	5	9	4	8	3	7	2	6	1	5	4	6	3	7
1	5	4	2	7	6	3	5	7	2	8	5	4	6	3	7	2	8	1	9	5	8	4	7	3
2	1	3	7	2	4	8	2	1	3	2	1	4	2	3	5	2	3	1	4	5	6	3	1	4

SAMPLES

10. DIGIT SYMBOL

1	2	3	4	5	6	7	8	9
-	T	□	L	U	O	V	X	=

SCORE 51

11. SIMILARITIES	Discontinue after 4 consecutive failures.	Score 2, 1, or 0
1. Orange—banana	they're fruit	2
2. Dog—lion	animals	2
3. Coat—suit	if you wear the on your shoulders	2
4. Boat—car	modes of transport	2
5. Eye—ear	sensory organs	2
6. Button—zip	clothe fastening devices	1
7. North—west	directions, compass directions	2
8. Egg—seed	the beginning of life,	2
9. Table—chair	items of furniture	2
10. Air—water	in the environment, plentiful	0
11. Poem—statue	they both say more than you remember something by	1
12. Work—play	things to what to divide the day, should be in equilibrium	1
13. Fly—tree	they live in the environment, both in an ecosystem	1
14. Praise—punishment	One's +ve, one's -ve, modes of reinforcement	1
Total		21
		Max - 28



269

WMS-R

Wechsler
Memory Scale-Revised

RECORD FORM

Name Alex BAYLIS
 Sex _____ Education _____
 Place of Testing _____
 Examiner _____
 Reason for Referral _____

	Year	Month	Day
Date of Testing	92	9	27
Date of Birth	70	8	25
Age	22		

SUBTEST RAW SCORES AND INDEXES

Subtest	Raw Score	Weight	Verbal Memory	Visual Memory	General Memory	Attention/Concentration	Delayed Recall
Information and Orientation ¹	13				↓		
Mental Control	5	x 1				5	
Figural Memory		x 1					
Logical Memory I // 1A	27	x 2	54				
Visual Paired Associates I		x 1					
Verbal Paired Associates I	22	x 1	22				
Visual Reproduction I // 2S		x 1					
Digit Span	15	x 2					30
Visual Memory Span	14	x 2					28
Logical Memory II	23	x 1					
Visual Paired Associates II		x 2					
Verbal Paired Associates II	8	x 2					
Visual Reproduction II		x 1					

Weighted Raw Score Sums	76	+		=		63	
Indexes	100					87	

¹This subtest is not used in the calculation of any of the Indexes.

THE PSYCHOLOGICAL CORPORATION
HARCOURT BRACE JOVANOVICH, INC.

Copyright © 1987 by The Psychological Corporation. Standard edition copyright © 1984 by The Psychological Corporation. All rights reserved. No part of this publication may be reproduced or transmitted in any form or by any means, electronic or mechanical, including photocopying, recording, or any information storage and retrieval system, without permission in writing from the publisher. Printed in the United States of America.

128

270

PERCENTILES FOR SELECTED SCORES

	<u>Raw Score</u>	<u>Percentile</u>
Digit Span Forward	<u>8</u>	<u>36</u>
Digit Span Backward	<u>7</u>	<u>52</u>
Visual Memory Span Forward	<u>7</u>	<u>22</u>
Visual Memory Span Backward	<u>7</u>	<u>26</u>
Logical Memory I	<u>28</u>	<u>54</u>
Logical Memory II	<u>23</u>	<u>53</u>
Visual Reproduction I	<u>37</u>	<u>76</u>
Visual Reproduction II	<u>38</u>	<u>93</u>

INFORMATION AND ORIENTATION QUESTIONS Administer all items exactly as worded.		Score
Questions	Responses	1 or 0
1. What is your full name?	Alexander Marcel Andrei Sebastian Bayliss	
2. How old are you?	22	
3. When were you born?	B 25/8/70	
4. Where were you born?	Castellon Vie	
5. What is your mother's first name?	Christine	
6. Who is the President of the United States?		1
7. Who was President before him?		1
8. What year is this?		1
9. What month is this?		1
10. What day of the month is this?		1
11. What is the name of the place you are in?		1
12. In what city is it?		1
13. What day of the week is it?		1
14. What time is it now?	actually 11.15 (10.32)	0
15. Are you left-handed or right-handed?		X
16. Do you have any difficulty in hearing?		X
Do you need glasses for reading?		X
Are you color-blind?		X
Max. = 14 Total		13

178

178

MENTAL CONTROL Administer all items.											Time	Errors	Score 2, 1 or 0			
1. (30 sec.)	20	19	18	17	16	15	14	13	12		5"	0	2			
	11	10	9	8	7	6	5	4	3	2				1		
2. (30 sec.)	A	B	C	D	E	F	G	H	I	J	K	L	M	3"	1	1
	N	O	P	Q	R	S	T	U	V	W	X	Y	Z			
3. (45 sec.)	1	4	7	10	13	16	19	22			8"	0	2			
	25	28	31	34	37	40										
												Max. = 6 Total	5			

FIGURAL MEMORY Administer all items.			
Item	Key	Response	Score 1 or 0
1	1		
2	3, 5, 8		Score 3, 2, 1, or 0
3	1, 6, 7		
4	2, 4, 9		
			Max. = 10 Total

LOGICAL MEMORY I Administer both stories. Score 1 point for each correct item (see Appendix A in Manual for Scoring Criteria).	Score
<p>Story A</p> <p>Anna / Thompson / ^{of} of South / Boston / ^{who works} employed / as a cook /</p> <p>in a school / cafeteria / reported / at the City Hall / Station /</p> <p>that she had been held up / ^{robbed} on State Street / ^{at ? Station} the night before /</p> <p>and robbed / of fifty-six dollars / She had four /</p> <p>small children / the rent was due / and they had not eaten /</p> <p>for two days / The police / ^{they were sympathetic} touched by the woman's story /</p> <p>took up a collection / for her /</p>	<p>4</p> <p>2</p> <p>3</p> <p>1</p> <p>2</p> <p>1</p>
<p>Max. = 25 Total Story A</p>	<p>13</p>
<p>Story B</p> <p>^{John ?} Robert / Miller / was driving / a ten-ton / truck /</p> <p>down a highway / at night / ^{he was going down} in the Mississippi / Delta /</p> <p>Call of carrying eggs / to Nashville / when his axle / broke /</p> <p>^{he} His truck skidded / ^{went to the side of the road} off the road / into a ditch /</p> <p>He was thrown / against the dashboard / and was badly shaken /</p> <p>There was no traffic / and he doubted that help would come /</p> <p>^{he heard} Just then his two-way radio / buzzed / He quickly answered /</p> <p>^{It was} "This is Grasshopper /"</p>	<p>3</p> <p>2</p> <p>2</p> <p>1</p> <p>2</p> <p>1</p> <p>1</p>
<p>Max. = 25 Total Story B</p>	<p>14</p>
<p>Max. = 50 Total Sum of Stories A + B</p>	<p>27</p>

Record clock time 11:19.

EFA

874

VISUAL PAIRED ASSOCIATES I

If the examinee answers all six items correctly on Set III, discontinue the subtest.
Otherwise, present Sets IV, V, and VI until all six items are correct.

SET I				SET II				SET III			
Item	Key	Response	Score 1 or 0	Item	Key	Response	Score 1 or 0	Item	Key	Response	Score 1 or 0
1	G			1	Y			1	B		
2	Pu			2	R			2	G		
3	R			3	B			3	Pu		
4	Y			4	Pu			4	Pk		
5	Pk			5	G			5	Y		
6	B			6	Pk			6	R		
Set I Total				Set II Total				Set III Total			
Max. = 18 Total Sets I-III											

SET IV				SET V				SET VI			
Item	Key	Response	Score 1 or 0	Item	Key	Response	Score 1 or 0	Item	Key	Response	Score 1 or 0
1	G			1	Pu			1	G		
2	Pu			2	B			2	Y		
3	R			3	Y			3	B		
4	Y			4	Pk			4	R		
5	Pk			5	R			5	Pu		
6	B			6	G			6	Pk		
Set IV Total				Set V Total				Set VI Total			

176

875

VERBAL PAIRED ASSOCIATES I If the examinee answers all eight items correctly on the third set, discontinue the subtest. Otherwise, present Sets IV, V, and VI until all eight items are correct.

SET I	Recall	Easy	Hard	SET IV	Recall	Easy	Hard
Metal—Iron	Fruit	✓	/	Crush—Dark	School	_____	_____
Baby—Cries	Obey	/	/	Cabbage—Pen	Metal	_____	_____
Crush—Dark	Rose	/	/	Fruit—Apple	Obey	_____	_____
School—Grocery	Baby	/	Patch	Obey—Inch	Crush	_____	_____
Rose—Flower	Cabbage	/	De	Baby—Cries	Fruit	_____	_____
Obey—Inch	Metal	✓	✓	Rose—Flower	Baby	_____	_____
Fruit—Apple	School	_____	✓	Metal—Iron	Cabbage	_____	_____
Cabbage—Pen	Crush	_____	✓	School—Grocery	Rose	_____	_____
Total		4	2	Total		_____	_____

SET II	Recall	Easy	Hard	SET V	Recall	Easy	Hard
Rose—Flower	Cabbage	_____	✓	Fruit—Apple	Rose	_____	_____
Cabbage—Pen	Baby	/	_____	School—Grocery	Crush	_____	_____
Obey—Inch	Metal	/	_____	Rose—Flower	Baby	_____	_____
Fruit—Apple	School	_____	✓	Cabbage—Pen	Metal	_____	_____
School—Grocery	Rose	✓	_____	Metal—Iron	Obey	_____	_____
Metal—Iron	Crush	✓	✓	Crush—Dark	Cabbage	_____	_____
Crush—Dark	Fruit	_____	✓	Baby—Cries	School	_____	_____
Baby—Cries	Obey	_____	✓	Obey—Inch	Fruit	_____	_____
Total		4	4	Total		_____	_____

SET III	Recall	Easy	Hard	SET VI	Recall	Easy	Hard
Baby—Cries	Obey	_____	✓	Metal—Iron	Baby	_____	_____
Crush—Dark	Fruit	✓	_____	Rose—Flower	Fruit	_____	_____
School—Grocery	Baby	/	_____	Crush—Dark	Cabbage	_____	_____
Rose—Flower	Metal	/	_____	Baby—Cries	Rose	_____	_____
Cabbage—Pen	Crush	_____	✓	Obey—Inch	School	_____	_____
Fruit—Apple	School	_____	✓	Fruit—Apple	Obey	_____	_____
Obey—Inch	Rose	✓	_____	Cabbage—Pen	Crush	_____	_____
Metal—Iron	Cabbage	_____	✓	School—Grocery	Metal	_____	_____
Total		4	4	Total		_____	_____

Total Sets I-III	Max. Easy = 12	Max. Hard = 12	Max. Total = 24
	12	10	22

VISUAL REPRODUCTION I Use VRI Copying Sheet.

Hand used: _____ Right _____ Left

Item	Score (see Visual Reproduction Scoring Summary)	Observations:
1		
2		
3		
4		
Max. = 41 Total		

27A

276

DIGIT SPAN Discontinue after failure on both trials of any item.
Administer both trials of each item, even if the first trial is passed.

DIGITS FORWARD					Score
Item	Trial I	Pass-Fail	Trial II	Pass-Fail	2, 1, or 0
1.	6-2-9	P	3-7-5	P	2
2.	5-4-1-7	P	8-3-9-6	P	2
3.	3-6-9-2-5	P	6-9-4-7-1	P	2
4.	9-1-8-4-2-7 914287	F	6-3-5-4-8-2	P	1
5.	1-2-8-5-3-4-6 128546	F	2-8-1-4-9-7-5 28149	P	1
6.	3-8-2-9-5-1-7-4 3851974	F	5-9-1-8-2-6-4-7 51826967	F	0
Max. = 12 Total Forward					8
DIGITS BACKWARD Administer Digits Backward even if examinee scores 0 on Digits Forward.					Score
Item	Trial I	Pass-Fail	Trial II	Pass-Fail	2, 1, or 0
1.	5-1	P	3-8	P	2
2.	4-9-3	P	5-2-6 652 s-c	P	2
3.	3-8-1-4	P	1-7-9-5	P	2
4.	6-2-9-7-2 7926	F	4-8-5-2-7	P	1
5.	7-1-5-2-8-6 685217	F	8-3-1-9-6-4 467821	F	0
6.	4-7-3-9-1-2-8		8-1-2-9-3-6-5		
Max. = 12 Total Backward					7
Max. Total = 24					15

VISUAL MEMORY SPAN Discontinue after failure on both trials of any item.
Administer both trials of each item, even if the first trial is passed.

TAPPING FORWARD					Score
Item	Trial I	Pass-Fail	Trial II	Pass-Fail	2, 1, or 0
1.	2-6	P	8-4	P	2
2.	2-7-5	P	8-1-6	P	2
3.	3-2-8-4 2384	F	2-6-1-5	P	1
4.	5-3-4-6-1	P	3-5-1-7-2 53176	F	1
5.	1-7-2-8-5-4	P	7-3-6-1-4-8 73148	F	1
6.	8-2-5-3-4-1-6 8753		4-2-6-8-3-7-5 4263758	F	0
7.	7-5-6-3-8-7-4-2 7		1-6-7-4-2-8-5-3		
Max. = 14 Total Forward					7
TAPPING BACKWARD Administer Tapping Backward even if examinee scores 0 on Tapping Forward.					Score
Item	Trial I	Pass-Fail	Trial II	Pass-Fail	2, 1, or 0
1.	3-6	P	7-4	P	2
2.	6-8-5	P	3-1-8	P	2
3.	8-4-1-6	P	5-2-4-1	P	2
4.	4-6-8-5-2	F	8-1-6-3-7 73168	F	1
5.	7-1-8-3-6-2	P	3-8-1-7-5-4		
6.	1-5-2-7-4-3-8		6-7-4-3-1-5-2		
Max. = 12 Total Backward					7
Max. Total = 26					14

877

877

Record clock time 10:49

LOGICAL MEMORY II Administer 30 minutes after Logical Memory I. Score 1 point for each correct item (see Appendix A in Manual for Scoring Criteria).	Score
<p>Story A</p> <p>Anna / Thompson / of South / Boston / ^{works} employed / as a cook /</p> <p>in a school / cafeteria / reported / ^{to the police} at the City Hall / Station /</p> <p>that she had been held up / on State Street / the night before /</p> <p>and robbed / ^{handing was stolen. It had \$56 in it} of fifty-six dollars / She had four /</p> <p>small children / the rent was due / and they had not eaten /</p> <p>two days / The police / touched by the woman's story /</p> <p>took up a collection / for her /</p>	<p>Reminder Given: <input type="checkbox"/> No <input type="checkbox"/> Yes</p> <p><u>1</u></p> <p><u>2</u></p> <p><u>3</u></p> <p><u>1</u></p> <p><u>2</u></p> <p><u>2</u></p>
<p style="text-align: right;">Max. = 25 Total Story A</p>	<p><u>11</u></p>
<p>Story B</p> <p>Robert / Miller / was driving / a ten-ton / truck /</p> <p>down a highway / ^{8-3 down} at night / in the Mississippi / Delta /</p> <p>carrying eggs / ^{fall of eggs from} to Nashville / had an accident / when his axle / broke /</p> <p>His truck skidded / He went onto a roadway / off the road / into a ditch /</p> <p>was thrown / against the dashboard / and was badly shaken /</p> <p>There was no traffic / and he doubted ^{he feared what he would be waiting} that help would come /</p> <p>Just then his ^{CB Grasshopper} two-way radio / buzzed / He quickly answered / ^{a tone true to take would be around to help her}</p> <p>"This is Grasshopper /"</p>	<p>Reminder Given: <input type="checkbox"/> No <input type="checkbox"/> Yes</p> <p><u>3</u></p> <p><u>2</u></p> <p><u>2</u></p> <p><u>2</u></p> <p><u>2</u></p> <p><u>2</u></p> <p><u>1</u></p>
<p style="text-align: right;">Max. = 25 Total Story B</p>	<p><u>12</u></p>
<p style="text-align: right;">Max. = 50 Total Sum of Stories A + B</p>	<p><u>23</u></p>

FFB

278

VISUAL PAIRED ASSOCIATES II			
Item	Key	Response	Score 1 or 0
1	Pk		
2	R		
3	G		
4	B		
5	Y		
6	Pu		
			Max. = 6 Total

VERBAL PAIRED ASSOCIATES II			
Stimulus Word (and correct response)	Response		
	Easy	Hard	
ROSE — (Flower)	<input checked="" type="checkbox"/>		
METAL — (Iron)	<input checked="" type="checkbox"/>		
SCHOOL — (Grocery)		<input checked="" type="checkbox"/>	
CABBAGE — (Pen)		<input checked="" type="checkbox"/>	
BABY — (Cries)	<input checked="" type="checkbox"/>		
CRUSH — (Dark)		<input checked="" type="checkbox"/>	
OBEY — (Inch)	<input checked="" type="checkbox"/>	<input checked="" type="checkbox"/>	
FRUIT — (Apple)	<input checked="" type="checkbox"/>		
Total	Max. = 4 <input checked="" type="checkbox"/>	Max. = 4 <input checked="" type="checkbox"/>	Max. Total = 8

VISUAL REPRODUCTION II Use VRII Copying Sheet.		
Hand used: <input type="checkbox"/> Right <input type="checkbox"/> Left		
Item	Score (see Visual Reproduction Scoring Summary)	
1	Observations:	
2		
3		
4		
Max. = 41 Total		

VISUAL REPRODUCTION SCORING SUMMARY (see Appendix B in Manual for Scoring Criteria).

	VR I	VR II		VR I	VR II
CARD A			CARD D		
Staffs:			Rectangles:		
1. Unbroken/straight/equal	<u>1</u>	<u>1</u>	1. Do not touch/intersect	<u>1</u>	<u>1</u>
2. Intersect at midpoints	<u>1</u>	<u>1</u>	2. Interior angles 90 degrees	<u>1</u>	<u>1</u>
3. Cross at right angles	<u>1</u>	<u>1</u>	3. Not rotated (15 degrees)	<u>1</u>	<u>1</u>
4. Not rotated (15 degrees)	<u>1</u>	<u>1</u>	4. 2 small to right of large	<u>1</u>	<u>1</u>
Flags:			5. Uppermost is taller	<u>0</u>	<u>0</u>
5. Correct direction	<u>1</u>	<u>1</u>	6. Bases of large and small level	<u>1</u>	<u>1</u>
6. Share side with staff	<u>1</u>	<u>1</u>	7. Top of large higher than small	<u>1</u>	<u>1</u>
7. Square in shape	<u>1</u>	<u>1</u>	8. Bases of 3 equally long	<u>1</u>	<u>1</u>
TOTAL	<u>7</u>	<u>7</u>	9. Height of large > width	<u>1</u>	<u>1</u>
			10. Heights of small < width	<u>1</u>	<u>1</u>
CARD B			Circle Segment:		
Circles:			11. Figure to right of rectangles	<u>1</u>	<u>1</u>
1. Large circle	<u>1</u>	<u>1</u>	12. Arc curves to right	<u>1</u>	<u>1</u>
2. Medium circle inside large circle	<u>1</u>	<u>1</u>	13. Symmetry/proportion	<u>1</u>	<u>1</u>
3. Small circle inside medium circle	<u>1</u>	<u>1</u>	14. Not rotated (15 degrees)	<u>1</u>	<u>1</u>
4. Large circle and medium circle touch (top)	<u>1</u>	<u>1</u>	Triangle:		
5. Small circle and medium circle touch (bottom)	<u>1</u>	<u>1</u>	15. Figure to right of segment	<u>1</u>	<u>1</u>
6. Round/closed	<u>0</u>	<u>0</u>	16. Vertex touches midpoint	<u>0</u>	<u>0</u>
7. Correct proportion	<u>1</u>	<u>1</u>	17. Contains 90 degree angle	<u>1</u>	<u>1</u>
TOTAL	<u>6</u>	<u>6</u>	18. Not rotated (15 degrees)	<u>1</u>	<u>1</u>
			TOTAL	<u>16</u>	<u>16</u>
			Total (Cards A through D) Max. = 41	<u>37</u>	<u>38</u>
CARD C			Notes:		
Large Square:					
1. Square in shape	<u>1</u>	<u>1</u>			
2. Vertical & horizontal lines	<u>1</u>	<u>1</u>			
3. Not rotated (15 degrees)	<u>1</u>	<u>1</u>			
4. Each quadrant has 4 dots	<u>0</u>	<u>1</u>			
Medium Squares:					
5. In 4 quadrants not touching	<u>1</u>	<u>1</u>			
6. Square in shape	<u>1</u>	<u>1</u>			
7. Vertical & horizontal lines	<u>1</u>	<u>1</u>			
8. None rotated (15 degrees)	<u>1</u>	<u>1</u>			
9. Equal size/proportion	<u>1</u>	<u>1</u>			
TOTAL	<u>8</u>	<u>9</u>			



BEHAVIORAL OBSERVATIONS

Attitude towards testing (e.g. rapport, work habits, interest, motivation, reaction to success/failure)

Attention

Visual/Auditory/Motor Problems

Language (receptive/expressive)

Physical Appearance

Affect

Unusual Behaviors/Thought Processes

Other Tests Administered

Diagnosis

Card A

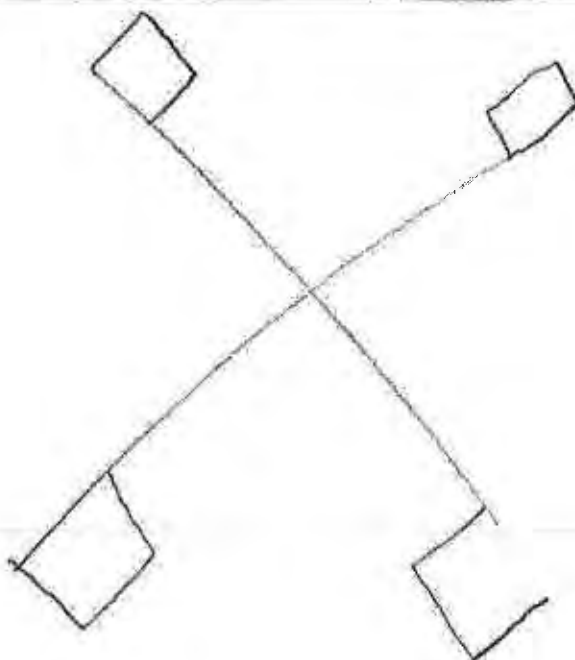

Card B



188

Card C

188

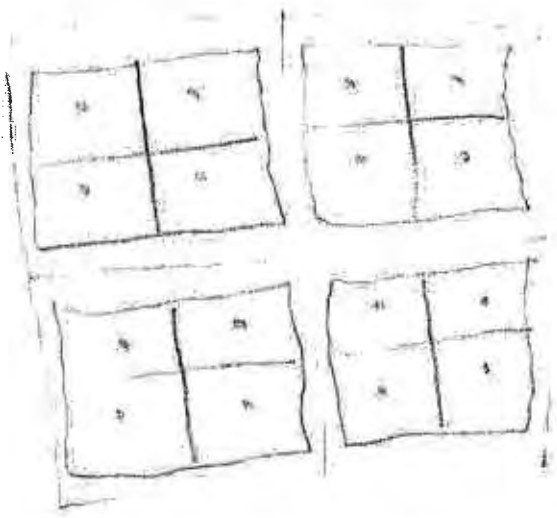

188

Card D



188

Card A

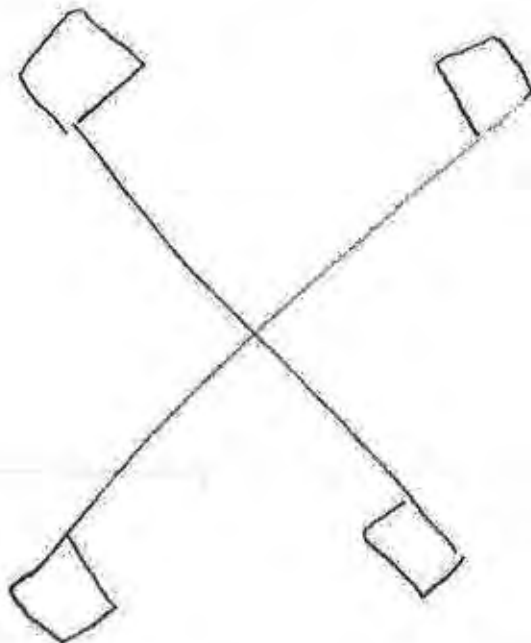

Card B

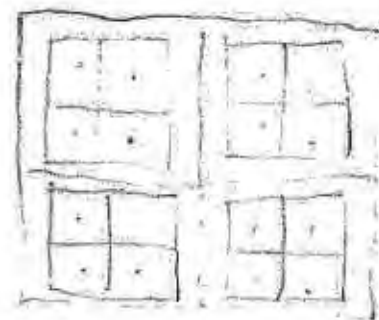
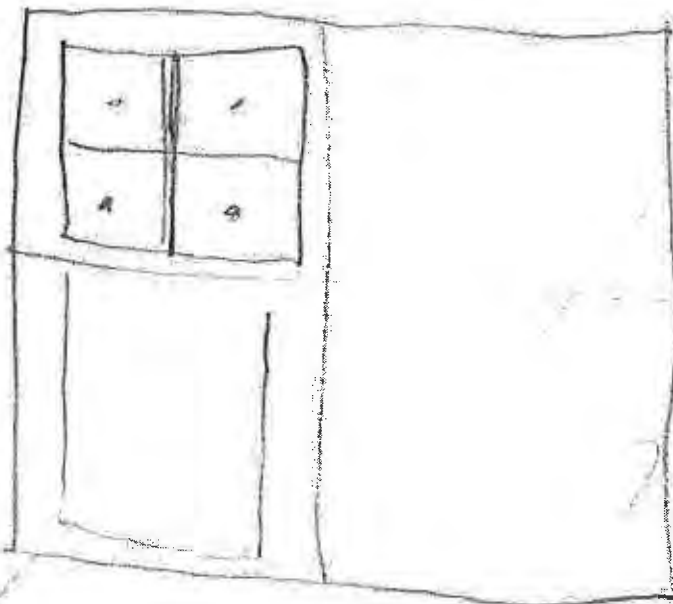

58A

Card C

024

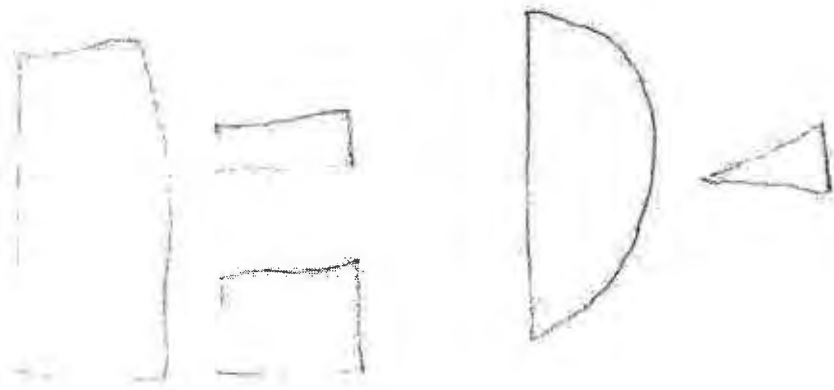

6

Card D

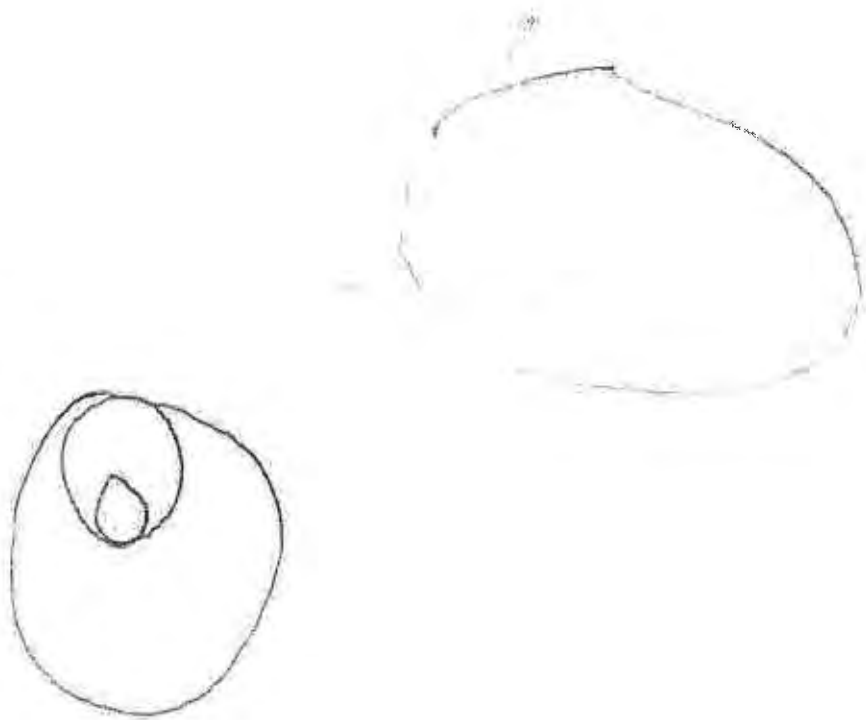

7

100

183

CVLT

CALIFORNIA VERBAL LEARNING TEST RESEARCH EDITION

ADULT VERSION

Dean C. Delis, Joel H. Kramer, Edith Kaplan, and Beth A. Ober

Examinee Information:

Name _____ ID No. _____

Sex _____ Age _____ Race _____ Education _____

Date of Birth _____ Occupation _____

Handedness _____ **Familial** Left-handedness? _____

Current Medications _____

Diagnoses* _____ Date of Onset _____

1. _____
2. _____
3. _____
4. _____
5. _____
6. _____

*Diagnoses should include history of: 1) neurological injury or disease, 2) medical illness, 3) psychiatric disorder, 4) loss of consciousness and duration of episode, 5) substance abuse, and/or 6) developmental learning disability.

Examiner _____ Date of Administration 24/9/92



Copyright © 1987, 1983 by The Psychological Corporation. All rights reserved. No part of this publication may be reproduced or transmitted in any form or by any means, electronic or mechanical, including photocopy, recording, or any information storage and retrieval system, without permission in writing from the publisher. Printed in the United States of America.

9-030503

550A

956

Summary of Scores:

	Raw Score	Standard Score ^a
Recall Measures (Number Correct)		
List A Total Trials 1-5 ^a	61	54
List A Trial 1	9	0
List A Trial 5	14	0
List B ^a	6	-1
List A Short-Delay Free Recall ^a	13	0
List A Short-Delay Cued Recall ^a	14	0
List A Long-Delay Free Recall ^a	13	0
List A Long-Delay Cued Recall ^a	14	0
Learning Characteristics, List A Trials 1-5		
Semantic Cluster Ratio (Observed/Expected) ^b	_____	_____
Serial Cluster Ratio (Observed/Expected) ^b	_____	_____
Percent of Correct Recall from: Primacy Region	_____	_____
: Middle Region	_____	_____
: Recency Region	_____	_____
Learning Slope (Increment in Words Recalled/Trial) ^b	_____	_____
Percent Recall Consistency Across Trials 1-5 ^b	_____	_____
Recall Errors (Lists A & B)		
Perseverations (Free and Cued Recall Total)	_____	_____
Free Recall Intrusions (Total)	_____	_____
Cued Recall Intrusions (Total)	_____	_____
Recognition Measures		
Recognition Hits ^a	_____	_____
Discriminability ^a	_____	_____
False Positives	_____	_____
Response Bias	_____	_____
	Percentage Change	Difference Score
Contrast Measures		
List B compared with List A Trial 1	_____	_____
Short-Delay Free Recall compared with List A Trial 5	_____	_____
Long-Delay Free Recall compared with Short-Delay Free Recall	_____	_____
Recognition Hits compared with Long-Delay Free Recall	_____	_____
Discriminability compared with Long-Delay Free Recall	_____	_____

^a Primary Score.

^b Index not easily computed by hand. See CVLT Research Edition Administration and Scoring Software.

^c For List A Total Trials 1-5, Mean = 50 and SD = 10; for all other indices, Mean = 0 and SD = 1.

888

887

Behavioral Notes and Observations:

988

**LIST A
(Monday
List)**

- drill
- plums
- vest
- parsley
- grapes
- paprika
- sweater
- wrench
- chives
- tangerines
- chisel
- jacket
- nutmeg
- apricots
- pliers
- slacks

LIST A: Immediate Free Recall, Trials 1-3

Instructions to Examinee:

Trial 1:

Let's suppose you were going shopping on Monday. I'm going to read a list of items for you to buy. Listen carefully, and when I'm through, I want you to say back as many of the items as you can. It doesn't matter what order you say them in — just tell me as many as you can. Are you ready?

Trial 2:

I'm going to repeat Monday's shopping list. Again, I want you to say back as many items as you can, in any order. Be sure to also say the items on the list that you told me the first time.

Trials 3-5:

I'm going to repeat Monday's shopping list. Again, I want you to say back as many items as you can, in any order, including items you may have already told me.

**KEY FOR CODING
RESPONSE TYPE**

- C = Correct
- P = Perseveration
- I = Intrusion

Trial 1 Responses		Type	Semantic Cluster
1	pliers	C	
2	slacks	C	
3	apricots	C	
4	paprika	C	
5	nutmeg	C I	
6	drill	C	
7	wrench	C I	
8	plums	C	
9	vest	C	
10			
11			
12			
13			
14			
15			
16			
17			
18			
19			
20			

Trial 2 Responses		Type	Semantic Cluster
1	drill	C	
2	vest	C	
3	pliers	C	
4	nutmeg	C	
5	parsley	C I	
6	chives	C I	
7	tangerines	C	
8	nutmeg	C	
9	wrench	C	
10	apricots	C	
11	(vest I've said that)		
12	parsley	P	
13	grapes	C	
14	plums	C I	
15			
16			
17			
18			
19			
20			

Trial 3 Responses		Type	Semantic Cluster
1	slacks	C	
2	jumped	C I	
3	vest	C I	
4	pliers	C	
5	drill	C I	
6	wrench	C I	
7	plums	C	
8	paprika	C	
9	parsley	C I	
10	chives	C I	
11	nutmeg	C I	
12	etc		
13			
14			
15			
16			
17			
18			
19			
20			

**LIST A: Immediate Free Recall,
Trials 4 & 5**

179

Trial 4 Responses		Type	Semantic Cluster
1	drill	C	
2	pest	C	
3	pliers	C	
4	paralel	C	
5	chives	C	I
6	apricots	C	
7	hang	C	I
8	jumped	C	
9	vest	C	I
10	slacks	C	I
11	wrench	C	
12	pliers	C	I
13	stragones	P	
14	paprika	C	
15	cherries	P	
16	jacket	C	
17			
18			
19			
20			

Trial 5 Responses		Type	Semantic Cluster
1	drill	C	
2	journal	C	I
3	pliers	C	I
4	chisel	C	I
5	plums	C	
6	paralel	C	
7	paprika	C	I
8	chives	C	I
9	nutmeg	C	I
10	spoons	C	
11	vest	C	
12	jumped	C	I
13	slacks	C	I
14	jacket	C	I
15			
16			
17			
18			
19			
20			

Table of Free-Recall Word Order							Short Delay	Long Delay
LIST A (Monday List)		Immediate						
		1	2	3	4	5		
drill								
plums								
vest								
paralel								
grapes								
psprita								
sweater								
wrench								
chives								
tangerines								
chisel								
jacket								
nutmeg								
apricots								
pliers								
slacks								
Serial cluster score:								

**Summary Table: LIST A (Monday List)
Immediate Free Recall**

TRIAL	Correct (C)	Perseverations (P)	Intrusions (I)	Semantic Cluster
1	9			
2	13			
3	11			
4	14	2		
5	14			
TOTAL	61			

**Table of Serial Position Recall:
LIST A Immediate Free Recall,
Trials 1-5**

Region	Number Correct	Percent of Total
Primacy		
Middle		
Recency		
TOTAL		100%

Record these totals in the Summary Table of Recall Errors (p. 9)

PTA

LIST B (Tuesday List)

Instructions: Now let's suppose that you planned to go shopping again on Tuesday. I'm going to read a **new** list of items for you to buy. When I'm through, I want you to say back as many as you can, in any order.

LIST B (Tuesday) List	Recall Order
toaster	
cherries	
halibut	
ginger	
pineapple	
spatula	
oregano	
flounder	
sage	
lemons	
cod	
skillet	
peaches	
salmon	
cinnamon	
bowl	

Responses		Type	Semantic Cluster
1	bowl	C	
2	cinnamon	C	
3	salmon	C	
4	cherry	I	
5	sage	C	
6	toaster	C	
7	salmon	P	
8	oregano	C	
9	cinnamon	P	
10			
11			
12			
13			
14			
15			
16			
17			
18			
19			
20			

Correct (C):	<u>6</u>
Perseverations (P):	<u>2</u>
Intrusions (I):	<u>1</u>
Semantic cluster score:	_____
Serial cluster score:	_____

890

LIST A: Short-Delay Free Recall

Instructions: Now I'd like you to tell me all of the shopping items you can from the Monday list.

Responses		Type	Semantic Cluster
1	dull	C	
2	plum	C	I
3	wrench	C	I
4	chisel	C	I
5	juniper	C	
6	jacket	C	I
7	nut	C	I
8	sticks	C	I
9	plum	C	
10	pantry	C	*
11	paprika	C	I
12	chips	C	I
13	ginger	C	
14			
15			
16			
17			
18			
19			
20			

Correct (C):	<u>13</u>
Perseverations (P):	_____
Intrusions (I):	_____
Semantic cluster score:	_____

SPB

A91

LIST A: Short-Delay Cued Recall

Instructions: Tell me all of the shopping items from the Monday list that are: (category)

Spices & Herbs:

Responses	Type
parsley	C
paprika	C
chives	C
nutmeg	C

Fruits:

Responses	Type
plums	C
strawberries	C

Tools:

Responses	Type
dull	C
pliers	C
wrench	C
chisel	C

Clothing:

Responses	Type
jumpers	C
jackets	C
vest	C
slacks	C

Correct (C):	<u>14</u>
Perseverations (P):	_____
Intrusions (I):	_____

Time of day Short-Delay
Cued Recall completed: 11:36

1PA

292

LIST A: Long-Delay Free Recall

Time of day Long-Delay Free Recall begun: 12:16

Time of day Short-Delay Cued Recall completed: 11:56

Total delay: _____

(Note: The total delay should be about 20 minutes.)

Instructions: I read some shopping items to you earlier. I'd like you to tell me all the items you can from the Monday list—that was the first list, the one that I read to you five times. Go ahead.

	Responses	Type	Semantic Cluster
1	dull	C	
2	pliers	C	i
3	wrench	C	i
4	chest	C	i
5	pliers	C	
6	paralel	C	
7	pap	C	i
8	n r	C	i
9	vaqueros	C	
10	jumpet	C	
11	jockey	C	i
12	slacks	C	i
13	net	C	i
14			
15			
16			
17			
18			
19			
20			

Correct (C):	<u>13</u>
Perseverations (P):	_____
Intrusions (I):	_____
Semantic cluster score:	_____

HPA

493

**LIST A:
Long-Delay Cued Recall**

Instructions: Tell me all of the shopping items from the Monday list that are: (category)

Clothing:

Responses	Type
jumpers	C
jackets	C
vest	C
slacks	C

Tools:

Responses	Type
dull	C
pliers	C
wrenches	C
chisel	C

Fruits:

peaches	C
pears	C
grapes	C

Spices & Herbs:

parsley	C
nutmeg	C
chives	C

Correct (C):	<u>74</u>
Perseverations (P):	_____
Intrusions (I):	_____

Summary Table of Recall Errors

Error Type	List A, Tr. 1-5 Total	List B	Short-Delay Recall		Long-Delay Recall		Total
			Free	Cued	Free	Cued	
Perseverations							
Intrusions: Free Recall							
Cued Recall							

LIST A: Long-Delay Recognition

Instructions: I'm going to read a list of shopping items. After I read each item, say "Yes" if the item was from the Monday list, and say "No" if it was not.

(Note: For each "Yes" response, place a (✓) in the one blank space to the right of the word; for each "No" response, leave the space blank.)

- | | |
|----|-------------------------------------|
| A | = List A-Correct (Hits) |
| BS | = List B-Shared |
| BN | = List B-Nonshared |
| NP | = Neither List-Prototypical |
| PS | = Neither List-Phonemically Similar |
| UN | = Neither List-Unrelated |

ITEM	A	FALSE POSITIVES				
		BS	BN	NP	PS	UN
Sweater	✓					
Oregano						
Flounder						
Rug						
Tires						
Pepper						
Jackpot	✓					
Aspirin						
Wax						
Drill	✓					
Apricots	✓					
Spatula						
Cherries						
Drums						
Chives	✓					
Film						
Chisel	✓					
Bratfennel						
Pistachio						
Tangerines	✓					
Clock						
Shoes						
Grapes	✓					
Salmon						
Paprika	✓					
Racket						
Ginger						
Socks	✓					
Books						
Parsley	✓					
Vest	✓					
Apples						
Grill						
Plums	✓					
Wrench	✓					
Lemons						
Tapes						
Vibrators						
Pliers	✓					
Bowl						
Hammer						
Nutmeg	✓					
Chimes						
Soap						

Discriminability:

$$(1 - \frac{\text{False Positives} + \text{Misses}}{44}) \times 100$$

$$= (1 - \frac{\quad}{\quad}) \times 100 = \quad$$

Response Bias:

$$\frac{\text{False Positives} - \text{Misses}}{\text{False Positives} + \text{Misses}} = \quad$$

Note: If False Positives = 0 or Misses = 0, substitute a value of 1 when computing Response Bias.

TOTAL					
POSSIBLE	16	4	4	4	8
A		BS	BN	NP	PS
					UN

Total number of hits: 16

Total number of false positives: 0

Misses = 16 - Hits = 0

008

199

CVLT General Questions

1. Is memory for List B notably worse than for Trial 1 of List A (which may reflect a clinically significant vulnerability to proactive interference)? Are more List B nonshared-category items recalled than shared-category items?

2. Is Short-Delay Free Recall of List A notably worse than Trial 5 of List A (which may reflect both the effects of the short-delay interval and a clinically significant vulnerability to retroactive interference)?

3. Does cued recall enhance memory performance over free recall (which may have implications for the relative integrity of encoding versus retrieval processes)?

4. What types of perseverations occur (e.g., proximal versus distal)? Are perseverations semantically clustered? What types of intrusions occur (e.g., novel intrusions; intrusions from the other CVLT list; semantically-related versus unrelated to CVLT items)? Do more intrusions occur on cued recall than on free recall? Error analysis can contribute to the characterization of different memory disorders.

5. Is recognition performance notably better than free recall and cued recall (which may have implications for the relative integrity of encoding versus retrieval processes)?

6. Do false positives occur on recognition? If so, what types (e.g., semantically related; phonemically related; from List B; etc.)? The nature of recognition errors may be related to problems in discriminability and/or response bias.

7. Other observations which reflect the examinee's learning strategy (e.g., semantic clustering versus serial-order clustering; primacy-recency effect; consistency of item recall and recall strategy across trials, as shown in the Free-Recall Word Order table)?

998

300

**THIS PAGE HAS BEEN
INTENTIONALLY LEFT
BLANK**